

TOSHIBA

Tecra S3 Series Detailed Product Specification¹

Model Name	Description	Part Number	UPC
S3-S411TD	Microsoft® Windows® XP Professional, Intel Pentium® M processor 740, 256MB DDR2, 40GB 5400rpm SATA, CDRW/DVD-ROM, 15.0"XGA, nVIDIA GeForce™ Go 6600 with 64MB, Intel PRO/Wireless 2200BG, 6-cell Li-Ion battery, 1-Year limited warranty	PTS30U-00S00E	032017412644

Operating System²

- Microsoft® Windows® XP Professional

Processor and Chipset³

Intel® Centrino™ Mobile Technology featuring:

- Choice of processors:
 - Intel Pentium® M Processor 740
 - 1.73GHz, 2MB L2, 533MHz FSB
 - Intel Pentium® M Processor 750
 - 1.86GHz, 2MB L2, 533MHz FSB
 - Intel Pentium® M Processor 760
 - 2.00GHz, 2MB L2, 533MHz FSB
 - Intel Pentium® M Processor 770
 - 2.13GHz, 2MB L2, 533MHz FSB
 - Intel Pentium® M Processor 780
 - 2.26GHz, 2MB L2, 533MHz FSB
- Chipset
 - Mobile Intel 915GM Express Chipset
- Integrated Wi-Fi™ compliant wireless LAN
 - Intel PRO/Wireless 2200BG (802.11b/g),
 - Intel PRO/Wireless 2915ABG (802.11a/b/g)

Memory⁴

- Configured with 256MB DDR2 SDRAM (using one memory module, one memory expansion slot open)
- 256MB(min)/2048MB (max), 2 memory slots using 256MB, 512MB, or 1024MB PC4200 DDR2 533MHz SDRAM, dual-channel support requires two memory modules of same capacity and clockspeed

Hard Disk Drive⁵

- Choice of: 40GB (5400 RPM), 60GB (5400 RPM), 80GB (5400RPM), or 100GB (5400RPM); Serial-ATA (SATA) hard disk drive; 9.5mm height; user removable

Ultra SlimBay Optical Disk Drive

- CD-RW/DVD-ROM drive maximum speed and compatibility:
 - CD-ROM (24x:read), CD-R (24x:write), CD-RW (24x:write), DVD-ROM (8x:read)
- DVD SuperMulti (+R double layer) drive supporting 10 formats maximum speed and compatibility:
 - CD-ROM (24x:read), CD-R (24x:write), CD-RW (10x:write), DVD-ROM (8x:read), DVD-R (4x:write), DVD-RW (2x:write), DVD+R (Single Layer, 4x: write), DVD+R (Double Layer, 2.4x:write), DVD+RW (2.4x:write), DVD-RAM (2x:write)

Display⁶

- 15.0" diagonal TFT active-matrix LCD display at 1024x768 native resolution (XGA)
- 15.0" diagonal TFT active-matrix LCD display at 1400x1050 native resolution (SXGA+)

Graphics⁷

- PCI-Express™ x16 graphics system
- NVIDIA GeForce™ Go 6600 with 64MB or 128MB DDR discrete graphics memory

Sound

- Sigmatel STAC9200 16-bit stereo software sound
 - Direct 3D Sound, DirectSound, Direct Music, MIDI (playback)
- Built-in microphone
- Sound Volume Control Dial
- Built-in stereo speakers

Input Devices

- Keyboard
 - 85 key US keyboard
 - Hot Key Functions (Fn)
 - Windows Key Function
 - Application Key Function
- Toshiba Accupoint™ and TouchPad™ dual pointing device
- TouchPad™ Enable/Disable (FN+F9 or by help of software)
- Control Buttons:
 - Toshiba Assist button to launch Toshiba Assist control panel
- Presentation button to quickly connect to projectors

Communications

- Toshiba V.92 software modem⁸
- Marvell Yukon Network Connection - 10/100/1000 Base-TX Ethernet
- Choice of Wireless-LAN:⁹
 - Integrated Intel Pro/Wireless Network Connection 2200BG (802.11b/g)
 - Integrated Intel Pro/Wireless Network Connection 2915ABG (802.11a/b/g)
- Bluetooth® version 2.0 plus Enhanced Data Range (EDR) with Toshiba Bluetooth driver software

Expandability

- 2 main memory slots. Both slots may be occupied.
- 1 PC Card slot support 1 Type II, PCMCIA R2.01, PC Card16, CardBus
- ExpressCard slot supporting ExpressCard/34 and ExpressCard/54
- Secure Digital slot (supports SDIO)

Ports

- RGB (monitor) port
- TV-out (S-Video)
- i.LINK(tm) IEEE-1394
- 3 Universal Serial Bus (USB) ports (v2.0)
- External Microphone jack
- Headphone jack
- RJ-45 LAN port
- RJ-11 modem port
- Parallel port
- Serial port

- Fast Infrared (4Mbps) port For FIR
- 240-pin docking connector

Physical Description for this Product Series

- Dimensions (WxDxH Front/H Rear): 13.5" (344.0mm) x 11.3" (286.0mm) x 1.18" (29.9mm)[F]/1.52" (38.6mm)[R] without feet
- Weight: Starting at 6.3 lbs (2.85 kg) depending upon configuration¹⁰
- Indicators: Main Battery Charging, DC-IN, Power/Sleep, HDD Activity, Wireless On, Caps Lock, Arrow Mode, Numeric Lock, SD Card
- Chassis Description
 - LCD Cover Color: Premium Silver
- Physical Security
 - Slot for cable lock;
 - Items protected by a screw: memory, hard drive, SlimBay Drive
- Software Security
 - Passwords: User power-on password, supervisor password
 - Hotkey locks: Screen Blank

Power Supply

- 75W (15V x 5A) Auto sensing external AC Adapter, 100-240V / 50-60Hz frequency (Universal) input.
- Dimensions (WxDxH): 5.0" (127.0mm) x 2.0" (51.0mm) x 1.20" (30.5mm)
- Weight: starting at 0.78 lbs (355 g)

Battery¹¹

- 6-cell (4700mAh) rechargeable, removable Lithium Ion (Li-Ion) battery pack
- Dimensions (WxDxH): 8.1" (207.0mm) x 0.79" (20.0mm) x 1.8" (45.0mm)
- Weight: starting at 0.75 lbs (338 g)
- Battery Life (measured by MobileMark™)¹²
 - Included 6-cell battery: 3 hours, 12 minutes
 - Optional 9-cell battery: 4 hours, 54 minutes
 - Optional 12-cell battery: 6 hours, 05 minutes
- Recharge Time
 - Main Battery (6-Cell) Off/On – approximately 3.0 hrs/approximately 3.5 to 13.0 hrs
 - Main Battery (9-Cell) Off/On – approximately 3.5 hrs/approximately 4.0 to 17.5 hrs
 - Main Battery (12-Cell) Off/On – approximately 4.5 hrs/approximately 5.0 to 21.5 hrs

Toshiba EasyGuard™

- Protect & Fix
 - Shock Absorbing Design¹³
 - HDD Shock Absorber
 - LCD Panel Shock Absorber
 - LCD Inverter Shock Absorber
 - Chassis Shock Protector
 - Hard Disk Drive Protection
 - 3D Accelerometer
 - HDD Shock Absorber
 - Spill-Resistant Keyboard
 - TOSHIBA PC Diagnostic Tool
 - TOSHIBA Software RAID 1 only
 - Key Component Access
- Secure
 - Multiple-Level Password Utilities
 - Fingerprint Reader (includes software for password and identity management)
 - Trusted Platform Module (TPM v1.1b)
 - TOSHIBA Secure Digital Token Utility
 - Reinforced Security Cable Lock Slot
 - Execute Disable Bit
 - Optional Services and Accessories (additional purchase required)
 - HDLock™ for Toshiba Notebooks
- Connect
 - Diversity Antenna

- TOSHIBA ConfigFree®
- Voice-over-IP Ready Design
- TOSHIBA Bluetooth® Stack
- Optimize
 - Presentation Button
 - TOSHIBA Zooming Utility
 - LCD Rotation Utility
 - One-touch Resolution Change
 - TOSHIBA Power Saver Utility
 - TOSHIBA Optical Disc Drive Power On/Off Utility
 - Wireless On/Off Switch
 - TOSHIBA Fn-esse® Shortcut Utility
 - TOSHIBA Mouse Utility
 - FN Shortcut Keys

BIOS

- ACPI v1.0b, PNP v1.0a, VESA v2.0, DPMS, DDC, SM BIOS v2.3, PCI BIOS v2.1 support

Software¹⁴

- Toshiba Software and Utilities
 - TOSHIBA ConfigFree®
 - TOSHIBA Custom Utilities
 - Electronic User's Guide
- Third-party Software
 - Microsoft Office® OneNote™ 2003
 - Microsoft Works™ Version 8.0
 - McAfee VirusScan™ (30-day trial)
 - Sun® Java™ 2 Runtime Environment
 - Adobe® Acrobat® Reader version 5.0
 - InterVideo® WinDVD® 5
 - InterVideo® WinDVD Creator 2 Platinum
 - Sonic Solutions® PrimeTime™
 - Sonic Solutions® RecordNow!™ Basic for Toshiba
 - Sonic Solutions® Drive Letter Access™ (DLA)
 - Microsoft® Windows Media Player version 10
 - AOL® Internet Service (90-day trial)¹⁵

Environmental Specifications

	Operating	Non-operating
Temperature ¹⁶	5° to 35° C (41° to 95° F)	-20° to 65° C (-4° to 149° F)
Thermal Gradient	15° C per hour (max)	20° C per hour (max)
Relative Humidity (non-condensing)	20% to 80%	10% to 95%
Altitude (relative to sea level)	-60 to 3,000 meters	-60 to 10,000 meters
Shock	7G, 1.5G with ODD	60G
Vibration	0.2G, 0.25G with ODD	1.0G

Tecra/Portégé – Build-to-Order with choice of 1 year or 3 year standard limited warranty

- Choice of:
 - Standard 1-year limited warranty, or
 - Standard 3-year limited warranty (battery and AC Adapter come standard with 1-year limited warranty)

Standard Limited Warranty Upgrades and Extensions

Toshiba offers many different standard limited warranty extensions and enhanced service plans such as SystemGuard®, At-Home Repair, and Service Express to provide additional support to your notebook PC. For a full description and complete list of programs and program terms and conditions, please visit www.pcsupport.toshiba.com

Recommended Services

Limited Warranty Extensions

Extends the standard limited warranty for up to 3 years from the original notebook purchase date. See Toshiba Service Plan Agreement for program terms and conditions at www.pcsupport.toshiba.com

Limited Warranty Extensions for standard 1-year limited warranty:

Part Number	Description
SWC-PEQQ2V	2nd Year Limited Warranty Extension
SWP-PEQQ3V	2nd/3rd Year Limited Warranty Extension

Limited Warranty Extensions for standard 3-year limited warranty:

Part Number	Description
SWC-PTQQ4V	4th Year Limited Warranty Extension

SystemGuard¹⁷ Advanced Protection Coverage with ServiceExpress

Provides advanced protection from damage caused by accidental drops, spills and even screen breakage. Select your express repair service with either Depot Express or Carry-In Express and go to the front of the line. Limited Warranty Extension included except with 1 Year plan.

SystemGuard¹⁸ Advanced Protection Coverage with ServiceExpress for standard 1-year limited warranty:

Part Number	Description
SWC-PSGQ1V	1st Year
SWC-PEGQ2V	1st/2nd Year + Limited Warranty Extension
SWP-PEGQ3V	1st/2nd/3rd Year + Limited Warranty Extension

SystemGuard¹⁹ Advanced Protection Coverage with ServiceExpress for standard 3-year limited warranty:

Part Number	Description
SWP-PQQQ3V	1st/2nd/3rd Year
SWC-PTGQDV	1st/2nd/3rd/4th Year + Limited Warranty Extension
SWC-PTGQ4V	4th Year Only + Limited Warranty Extension

SystemGuard²⁰ Advanced Protection Coverage + Business On-Site Repair

Combines SystemGuard and Business On-Site Repair coverage. Limited Warranty Extension included except with 1 Year plan.

SystemGuard²¹ Advanced Protection Coverage + Business On-Site Repair for standard 1-year limited warranty:

Part Number	Description
SWC-PSGN1V	1st Year
SWC-PEGN2V	1st/2nd Year + Limited Warranty Extension
SWP-PEGN3V	1st/2nd/3rd Year + Limited Warranty Extension

SystemGuard²² Advanced Protection Coverage + Business On-Site Repair for standard 3-year limited warranty:

Part Number	Description
SWP-PQGN3V	1st/2nd/3rd Year
SWC-PTGNDV	1st/2nd/3rd/4th Year + Limited Warranty Extension
SWC-PTGN4V	4th Year Only + Limited Warranty Extension

ServiceExpress

Select your express repair service with either Depot Express or Carry-In Express. Depot Express: Toshiba will make reasonable efforts to complete repair of your notebook and return the notebook to you by the next business day via overnight shipment (excluding weekends and holidays). Instructions and box will be provided to you for packing and shipping the notebook to Toshiba. Carry-In Express: A Premier ASP will make reasonable efforts to complete repair of your notebook by the next business day (excluding weekends and holidays). Limited Warranty Extension included except with 1 Year plan. See Toshiba Service Plan Agreement for program terms and conditions at www.pcsupport.toshiba.com

ServiceExpress for standard 1-year limited warranty:

Part Number	Description
SWC-PSQP1V	1st Year
SWC-PEQP2V	1st/2nd Year + Limited Warranty Extension
SWP-PEQP3V	1st/2nd/3rd Year + Limited Warranty Extension

ServiceExpress for standard 3-year limited warranty:

Part Number	Description
SWP-PQQP3V	1st/2nd/3rd Year

SWC-PTQPDV	1st/2nd/3rd/4th Year + Limited Warranty Extension
SWC-PTQP4V	4th Year Only + Limited Warranty Extension

Business On-Site Repair

Toshiba will make reasonable efforts to provide on-site service at customer's business location by the next business day (excluding weekends and holidays) to perform the necessary hardware repairs. Limited Warranty Extension included except with 1 Year plan. See Toshiba Service Plan Agreement for program terms and conditions at www.pcsupport.toshiba.com

Business On-Site Repair for standard 1-year limited warranty:

Part Number	Description
SWC-PSQN1V	1st Year
SWC-PEQN2V	1st/2nd Year + Limited Warranty Extension
SWP-PEQN3V	1st/2nd/3rd Year + Limited Warranty Extension

Business On-Site Repair for standard 3-year limited warranty:

Part Number	Description
SWP-PQQN3V	1st/2nd/3rd Year
SWC-PTQNDV	1st/2nd/3rd/4th Year + Limited Warranty Extension
SWC-PTQN4V	4th Year Only + Limited Warranty Extension

Accessories

For additional and most updated accessories, please visit www.accessories.toshiba.com

Memory

Part Number	Description
PA3389U-2M25	Toshiba 256MB DDR2 533 Memory Kit
PA3412U-2M51	Toshiba 512MB DDR2 533 Memory Kit
PA3411U-2M1G	Toshiba 1GB DDR2 533 Memory Kit

Power

Part Number	Description
PA3283U-3ACA	Toshiba 75W Global AC Adapter, RoHS
PA3356U-2BRS	Toshiba Primary Li Ion Battery Pack (6 Cell)
PA3509U-1BRM	Toshiba Primary Extended Capacity Battery Pack (9 Cell), RoHS
PA3357U-1BRL	Toshiba Primary High Capacity Li Ion Battery Pack (12 Cell)
PA3091U-2CHG	Toshiba Battery Charger w/Integrated AC Adapter, RoHS

Expansion

Part Number	Description
PA3474U-1PRP	Toshiba Advanced Port Replicator III Plus w/75W AC Adapter, RoHS
PA3410U-1DV2	Toshiba Ultra SlimBay DVD SuperMulti Drive Kit (Black)

Security & Protection

Part Number	Description
PA1370U-1ETC	Toshiba Keyboard Protector (Satellite/Tecra/Qosmio)
PA410U	Targus DEFCON CL Notebook Cable Lock

Storage

Part Number	Description
PA3109U-3FDD	Toshiba USB Floppy Disk Drive Kit, RoHS
PA1399U-1MEM	Toshiba 1GB USB Hi-Speed Flash Drive
PA3407U-1H80	Toshiba 80GB HDD Kit (with Bracket) 5400rpm S-ATA
PA3430U-1HA0	Toshiba 100GB HDD Kit (with Bracket) 5400rpm S-ATA
PA3408U-1ETC	Toshiba Ultra SlimBay HDD Adapter (Black Bezel)

Wireless/Bluetooth

Part Number	Description
PA3455U-1BTM	Toshiba USB Adapter with Bluetooth 2.0+EDR capability
PA1380U-1NMS	Toshiba Wireless Travel Mouse with Bluetooth Technology
PA1381U-1ETC	Toshiba Wireless Audio Headphones with Bluetooth Technology

Subject to Change

While Toshiba has made every effort at the time of publication to ensure the accuracy of the information provided herein, product specifications, configurations, prices, system/component/options availability are all subject to change without notice. For the most up-to-date product information about your computer, or to stay current with the various computer software or hardware options, visit Toshiba's Web site at <http://www.pcsupport.toshiba.com>

Return Policy

Notwithstanding anything to the contrary in any third party License Agreement or product documentation supplied with your PC, Toshiba America Information Systems, Inc. ("TAIS") does not accept the return of component parts, or bundled software, that have been removed from the PC system. Pro-rata refunds on individual PC components or bundled software, including the operating system, will not be granted. If you wish to return a complete PC system, contact the TAIS dealer where you purchased the product, and comply with the dealer's standard return policies and procedures.

Toshiba America Information Systems, Incorporated ("TAIS")
9740 Irvine Boulevard
Irvine CA 92618
ToshibaDirect website: <http://www.toshibadirect.com>
TAIS website for resellers: <http://sell.toshiba.com>
TAIS PC Support website: <http://pcsupport.toshiba.com>

Portégé, Satellite, Tecra, SelectBay, ConfigFree and SystemGuard are registered trademarks and Qosmio and EasyGuard are trademarks of Toshiba America Information Systems, Inc. and/or Toshiba Corporation. Intel, Celeron, Centrino, Intel Inside, Pentium, the Intel Centrino logo, and the Intel Inside logo are trademarks or registered trademarks of Intel Corporation or its subsidiaries in the United States and other countries. Microsoft and Windows are registered trademarks and OneNote registered is a trademark of Microsoft Corporation in the United States and/or other countries. Winstone® is a registered trademark and BatteryMark™ is a trademark of Ziff Davis Publishing Holdings Inc. in the U.S. and other countries. MobileMark™ is a trademark of the Business Applications Performance Corporation. Wi-Fi is a registered certification mark of the Wi-Fi Alliance. The Bluetooth word mark and logos are owned by the Bluetooth SIG, Inc. and any use of such marks by Toshiba is under license. NVIDIA and GeForce are registered trademarks or trademarks of NVIDIA Corporation in the United States and/or other countries. All other trademarks are the property of their respective owners.

RoHS Compliance

The TECRA S3 is fully compliant with the RoHS (Reduction of Hazardous Substances) standard being implemented by the European Union which requires that manufacturing be free of 6 identified hazardous substances. The substances identified as hazardous are: Cadmium, Hexavalent Chromium, Lead, Mercury, PBBs (Polybromobiphenyls) and PBDEs (Polybromodiphenylethers). In addition to the manufacturing the packaging materials also comply with the RoHS Standard.

¹ **Product Series Legal Footnote.** The product specifications and configuration information are designed for a product Series. Your particular model may not have all the features and specifications listed or illustrated. For more detailed information about the features and specifications on your particular model, please visit Toshiba's Web site at pcsupport.toshiba.com.

Product Offering Legal Footnote. Toshiba America Information Systems, Inc. reserves the right to modify or withdraw this offer at anytime without notice.

² **Operating System.** Certain Microsoft® software product(s) included with this computer may use technological measures for copy protection. IN SUCH EVENT, YOU WILL NOT BE ABLE TO USE THE PRODUCT IF YOU DO NOT FULLY COMPLY WITH THE PRODUCT ACTIVATION PROCEDURES. Product activation procedures and Microsoft's privacy policy will be detailed during initial launch of the product, or upon certain reinstallations of the software product(s) or reconfigurations of the computer, and may be completed by Internet or telephone (toll charges may apply).

Some software may differ from its retail version (if available), and may not include user manuals or all program functionality.

³ **Processor (Central Processing Unit).**

CPU performance in your computer product may vary from specifications under the following conditions:

1. use of certain external peripheral products
2. use of battery power instead of AC power
3. use of certain multimedia, computer generated graphics or video applications
4. use of standard telephone lines or low speed network connections
5. use of complex modeling software, such as high end computer aided design applications
6. use of several applications or functionalities simultaneously
7. use of computer in areas with low air pressure (high altitude >1,000 meters or >3,280 feet above sea level)
8. use of computer at temperatures outside the range of 5°C to 30°C (41°F to 86° F) or >25°C (77°F) at high altitude (all temperature references are approximate and may vary depending on the specific computer model – please visit the Toshiba website at www.pcsupport.toshiba.com for details).

CPU performance may also vary from specifications due to design configuration.

Under some conditions, your computer product may automatically shut-down. This is a normal protective feature designed to reduce the risk of lost data or damage to the product when used outside recommended conditions. To avoid risk of lost data, always make back-up copies of data by periodically storing it on an external storage medium. Use your computer product only under recommended conditions. Read additional restrictions under "Environmental Conditions" in your product "Detailed Specs." Contact Toshiba Technical Service and Support for more information.

TOSHIBA

⁴ **Memory (Main System).** Part of the main system memory may be used by the graphics system for graphics performance and therefore reduce the amount of main system memory available for other computing activities. The amount of main system memory allocated to support graphics may vary depending on the graphics system, applications utilized, system memory size and other factors.

⁵ **Hard Disk Drive (HDD) Capacity.**

1 Gigabyte (GB) means $1000 \times 1000 \times 1000 = 1,000,000,000$ bytes using powers of 10. The computer operating system, however, reports storage capacity using powers of 2 for the definition of 1 GB = $1024 \times 1024 \times 1024 = 1,073,741,824$ bytes, and therefore may show less storage capacity. Available storage capacity will also be less if the product includes one or more pre-installed operating systems, such as Microsoft Operating System and/or pre-installed software applications, or media content. Actual formatted capacity may vary.

⁶ **Display.** Small bright dots may appear on your screen display when you turn on your PC. Your display contains an extremely large number of thin-film transistors (TFT) and is manufactured using high-precision technology. Any small bright dots that may appear on your display are an intrinsic characteristic of the TFT manufacturing technology. Over a period of time, and depending on the usage of the computer, the brightness of the screen will deteriorate. This is also an intrinsic characteristic of the screen technology.

When the computer is operated on battery power, the screen will dim and you may not be able to increase the brightness of the screen while on battery power.

⁷ **Graphics (Graphics Processing Unit).**

GPU performance may vary depending on product model, design configuration, applications, power management settings and features utilized. GPU performance is only optimized when operating in AC power mode and may decrease considerably when operating in battery power mode.

⁸ **Modem Speed.** Due to FCC limitations, speeds of 53 kbps are the maximum permissible transmission rates during download. Actual data transmission speeds will vary depending on line conditions.

⁹ **Wireless.** Wireless connectivity and some features may require you to purchase additional software, external hardware or services. Availability of public wireless LAN access points may be limited. The transmission speed over the wireless LAN and the distance over which wireless LAN can reach may vary depending on surrounding electromagnetic environment, obstacles, access point design and configuration, and client design and software/hardware configurations. The actual transmission speed will be lower than the theoretical maximum speed. To use the Atheros SuperAG™ or SuperG™ wireless function, if available, your client and access point must support the corresponding feature. Performance of these functions may vary depending on the format of data transmitted.

¹⁰ **Weight.** Weight may vary depending on product configuration, vendor components, manufacturing variability and options selected.

¹¹ **Battery Life.** Battery life may vary considerably from specifications depending on product model, configuration, applications, power management settings and features utilized, as well as the natural performance variations produced by the design of individual components. Published battery life numbers are achieved on select models and configurations tested by Toshiba at the time of publication. See "Detailed Specs" for specific battery measurement test. Recharge time varies depending on usage. Battery may not charge while computer is consuming full power. After a period of time, the battery will lose its ability to perform at maximum capacity and will need to be replaced. This is normal for all batteries. To purchase a new battery pack, see the accessories information that shipped with your computer or visit the Toshiba web site at www.accessories.toshiba.com.

¹² **Battery Life - MobileMark™.** Measured by MobileMark. MobileMark is a trademark of the Business Applications Performance Corporation.

¹³ **Shock Protection.** Toshiba's shock absorption technology provides higher impact protection for your system as compared to Toshiba systems without similar shock protection features based on Toshiba's drop tests. Toshiba's standard limited warranty terms and limitations apply. Visit www.warranty.toshiba.com for details.

¹⁴ **Software.** Some software may differ from its retail version (if available), and may not include user manuals or all program functionality.

Certain Microsoft® software product(s) included with this computer may use technological measures for copy protection. IN SUCH EVENT, YOU WILL NOT BE ABLE TO USE THE PRODUCT IF YOU DO NOT FULLY COMPLY WITH THE PRODUCT ACTIVATION PROCEDURES. Product activation procedures and Microsoft's privacy policy will be detailed during initial launch of the product, or upon certain reinstallations of the software product(s) or reconfigurations of the computer, and may be completed by Internet or telephone (toll charges may apply).

¹⁵ **AOL® Internet Service.** Availability may be limited, especially during peak times. TO AVOID BEING CHARGED A MONTHLY MEMBERSHIP FEE, SIMPLY CANCEL BEFORE THE THREE-MONTH PROMOTIONAL PERIOD ENDS. Premium services carry surcharges and communication surcharges may apply, including AK, even during promotional period. Members may incur telephone charges on their phone bill, depending on their location and calling plan, even during promotional period. Available to new AOL members in the United States, age 18 or older; a major credit card or checking account is required.

¹⁶ **Temperature (Environmental) Conditions.** All temperature references are approximate and the performance of your computer may vary from specifications even when operating within the recommended temperature range.

¹⁷ **SystemGuard:** SystemGuard coverage must be purchased within the first 30 days of purchase. See Toshiba Service Plan Agreement for program terms and conditions at www.pcsupport.toshiba.com

¹⁸ **SystemGuard:** SystemGuard coverage must be purchased within the first 30 days of purchase. See Toshiba Service Plan Agreement for program terms and conditions at www.pcsupport.toshiba.com

¹⁹ **SystemGuard:** SystemGuard coverage must be purchased within the first 30 days of purchase. See Toshiba Service Plan Agreement for program terms and conditions at www.pcsupport.toshiba.com

²⁰ **SystemGuard:** SystemGuard coverage must be purchased within the first 30 days of purchase. See Toshiba Service Plan Agreement for program terms and conditions at www.pcsupport.toshiba.com

²¹ **SystemGuard:** SystemGuard coverage must be purchased within the first 30 days of purchase. See Toshiba Service Plan Agreement for program terms and conditions at www.pcsupport.toshiba.com

²² **SystemGuard:** SystemGuard coverage must be purchased within the first 30 days of purchase. See Toshiba Service Plan Agreement for program terms and conditions at www.pcsupport.toshiba.com

Front with display open

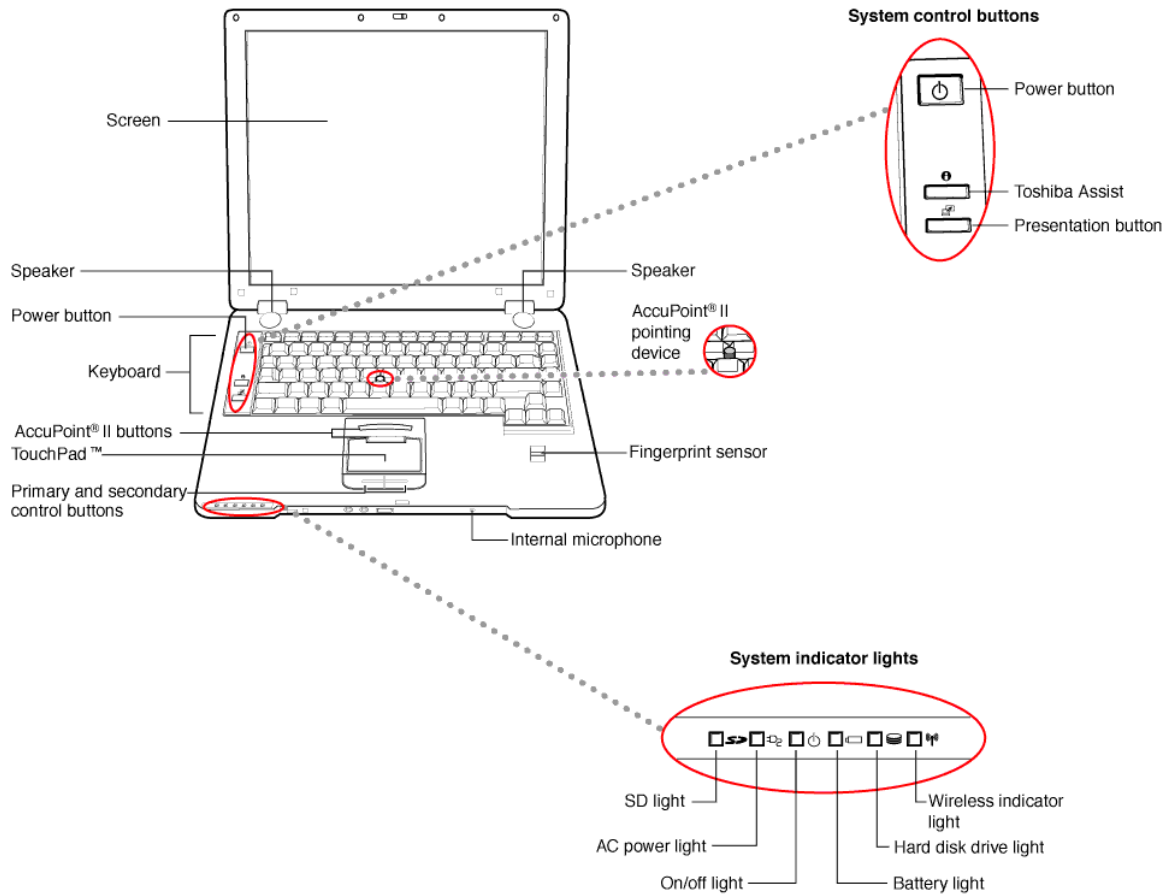

Front with display closed

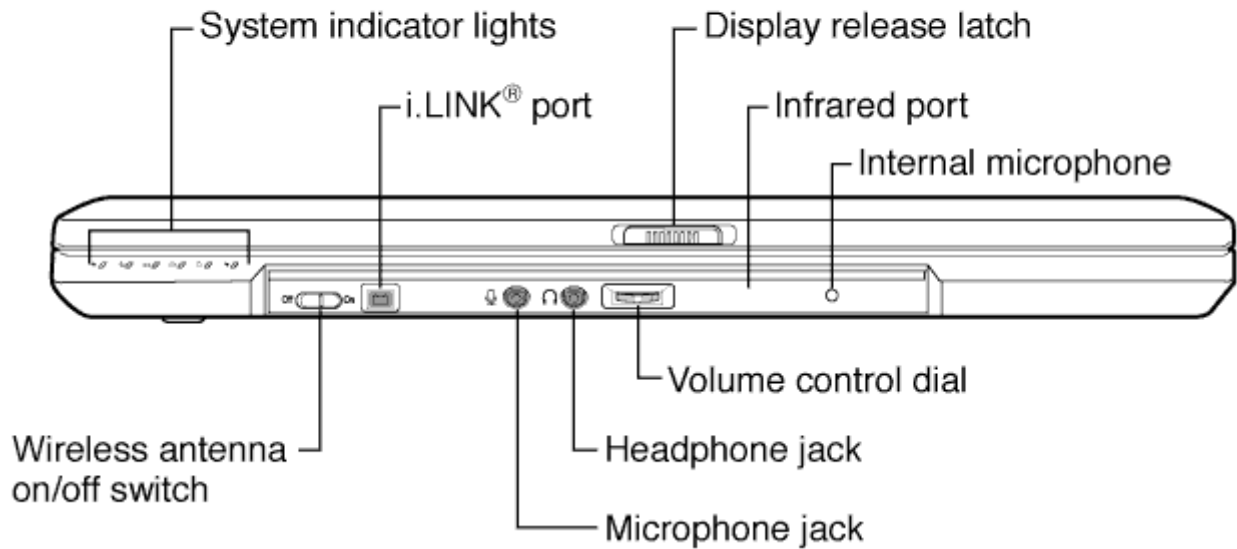

Left side

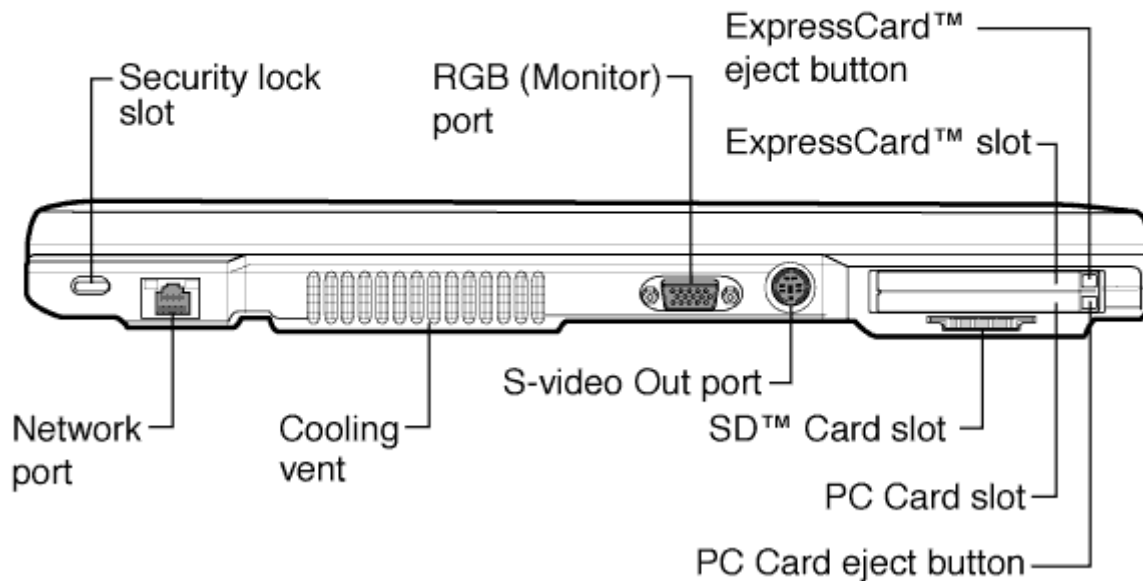

Right side

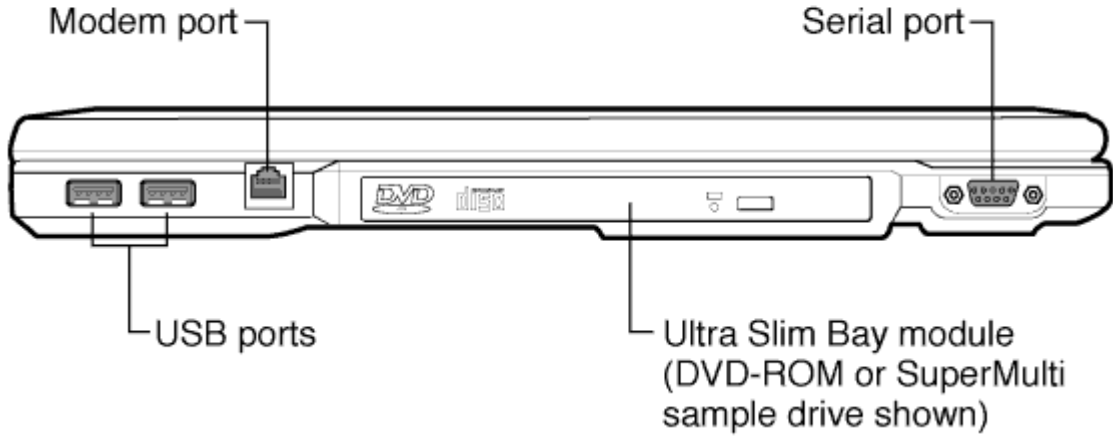

Back

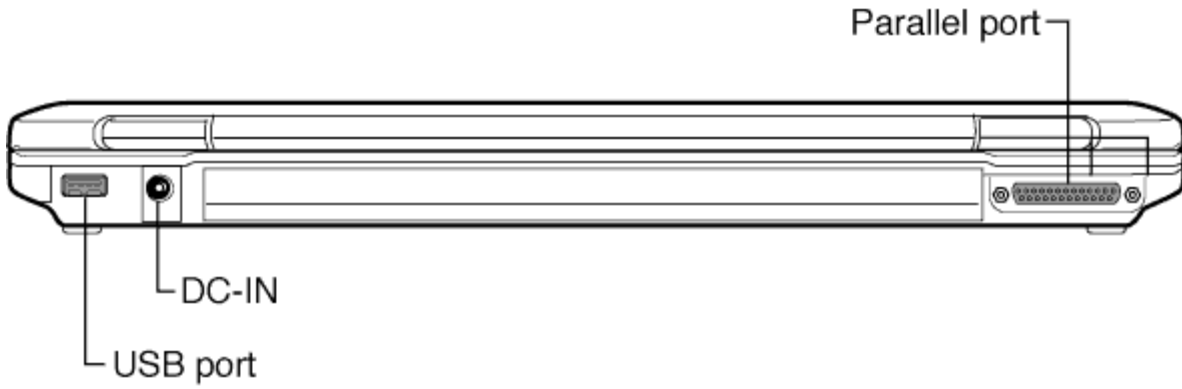

Underside

